



SIG 
NAL 
YARD 



New retail units

Signal Yard, 5-10 Park Drive,
Milton Park, Oxfordshire OX14 4RS

 Milton Park™

Introducing Signal Yard at Milton Park – situated within a beautifully landscaped setting, Signal Yard brings 18 state of the art, new-build units offering a vibrant mix of food & beverage, retail and leisure venues. Perfectly positioned to serve both Milton Park and local residents, Signal Yard will become a new community hub and vibrant amenity destination.

Designed with convenience in mind, Signal Yard benefits from community welfare facilities and boasts excellent public transport connections. There will be an array of bicycle storage and dedicated customer parking bays equipped with EV charging stations.

18
Retail & leisure units

6
Restaurants, cafés and bars

9,000
Employees on-site set to double over next 15 years

4,200
Dwellings under construction adjacent to Milton Park



Rapid & fast EV chargers

Targeting BREEAM Excellent and EPC Rating: A



Didcot Parkway Station

Didcot

Sutton Courtenay

4,234
New homes
Phase 1 now under construction

Milton Village



Floor plans

- Food & Beverage
- Services
- Welfare Facilities
- Office Space

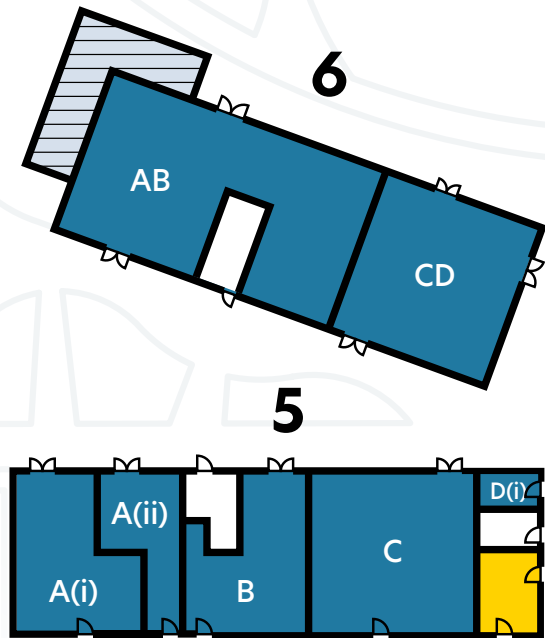

Yard level (Ground floor)



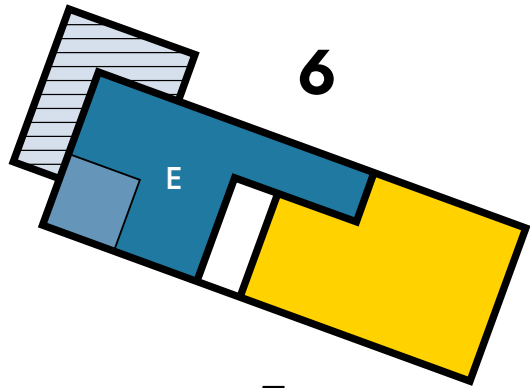

5

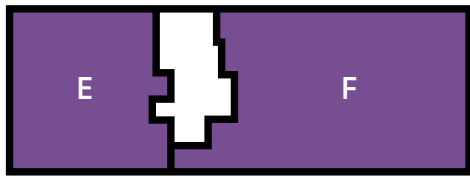

Signal level

(First floor)

7

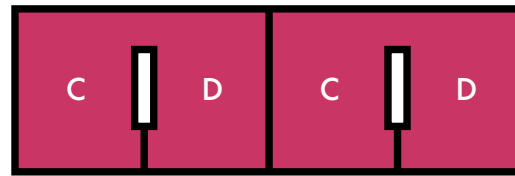

8

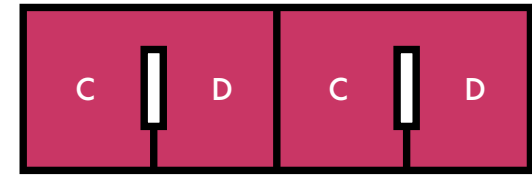

9

10

- Food & Beverage
- Services
- Welfare Facilities
- Office Space



200,311*

Total catchment population

60%*

Over 60% market share in core catchment

29,000*

New homes proposed in Didcot and surrounding areas

£75m*

Potential market spend in catchment area

*Reference: CACI 2024

Signal Yard catchment area



 Milton Park

24,035

19,682

43,717

21,446

135,148

Total: 200,311



Get in touch with us...



Tom Vecchione
Associate Director
Benedicts
tom@benedicts.co.uk
+44 (0)7807 791328



Clare Fleet
Commercial Surveyor
MEPC
clare.fleet@federatedhermes.com
+44 (0)7824 554085



MEPC, Bee House, 140 Eastern Avenue, Milton Park, Oxfordshire OX14 4SB
///feasted.cloud.honeybees
+44 (0)1235 865555 | marketing@miltonpark.com | miltonpark.com

